

steel cored nylon roundbar lever furniture

The lever style shown in this section is available on the following rose and plate fixing options

Please suffix lever code with plate option no., followed by profile digit and colour abbreviation

(eg. 419 lever - on concealed radiussed plate (4) - euro profile (P) - silver grey (SGR) would be: 419/4PSGR)

on rose (0)



concealed rose

plate 2

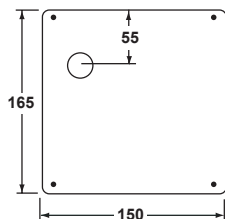

face fixed square

plate 3

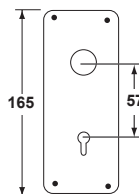

face fixed oblong

plate 4

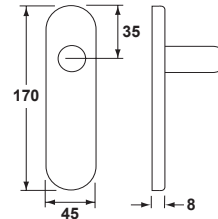

concealed radiussed

Piercings on all variants of backplates featured within this section are supplied at standard UK centres and are as follows:

Europrofile lock plates (P) are 47.5mm from the centre of the spindle follower and the centre of the cylinder and Oval profile (U) are 48.5mm

Lock (L) and Bathroom (B) backplates are 57mm centres between the centre of the spindle follower and the middle of the keyway/bathroom turn

However, backplates with centres that differ from those detailed above can be produced upon special request.

RAL 9002 ivory coast (IC)	RAL 1023 mellow yellow (MY)	RAL 1004 daffodil yellow (DY)	RAL 3003 flame red (FR)	RAL 3005 bordeaux red (BR)	RAL 3007 plum red (PR)	RAL 8017 burnt sienna (BS)	RAL 8017 chocolate brown (CB)	RAL 8019 burnt oak (BO)	RAL 9005 raven black (RB)
RAL 7043 slate grey (SG)	RAL 7036 elephant grey (EG)	RAL 7036 silver grey (SGR)	RAL 9016 snow white (SW)	RAL 5002 royal blue (RBL)	RAL 5003 denim blue (DB)	RAL 5003 deep blue (DBL)	RAL 6009 bottle green (BG)	RAL 6016 emerald green (EG)	RAL 6014 olive green (OG)

20mm dia. return to door lever

419



	latch	lock (L)	euro (P)	oval (U)	bath (B)
on rose (0) (unsprung)	419/0	-	-	-	-
	13.40	-	-	-	-
plate 2	419/2	419/2L	419/2P	419/2U	419/2B
	16.00	25.00	25.00	25.00	28.37
plate 3	419/3	419/3L	419/3P	419/3U	419/3B
	16.00	25.00	25.00	25.00	28.37
plate 4	419/4	419/4L	419/4P	419/4U	419/4B
	16.00	25.00	25.00	25.00	28.37

escutcheons, turns & indicators



4EL
2.40



4EP
2.40



4EU
2.40



4BT
6.00



4DBT
10.10

roundbar pull handles



	178 (x 20mm dia.)	250 (x 30mm dia.)	300 (x 34mm dia.)	425 (CC) (x 34mm dia.)
bolt through	450/178BF	450/250BF	450/300BF	450/425BF
	20.00	30.00	38.00	##.##
concealed fix	-	450/250CF	450/300CF	450/425CF
	-	32.00	40.00	##.##
back to back	-	450/250BB	450/300BB	450/425BB
	-	63.00	75.00	##.##

please note: special sized pull handles can be produced upon request



	225 (x 30mm dia.)	300 (x 34mm dia.)
face fixed	456/250	456/300
	33.00	41.00
engraved 'PUSH'	456/250PH	456/300PH
	39.00	46.00
engraved 'PULL'	456/250PL	456/300PL
	39.00	46.00



	210 (x 30 dia.)	300 (x 34 dia.)
bolt through	452/210BF	452/300BF
	27.00	35.00
back to back	452/210BB	452/300BB
	55.00	72.00

entrance pull handles



	210mm (30mm dia.)	
bolt through	454/210BF	
	45.00	
back to back	454/210BB	
	92.00	



please note:
special sized pull handles on pegs
can be produced upon request

	300 (34mm dia.)	1000 (34mm dia.)	1500 (34mm dia.)
bolt through	457/300BF	457/1000BF	450/1500BF
	110.00	160.00	200.00
back to back	457/300BB	457/1000BB	450/1500BB
	225.00	325.00	405.00



	295mm (34mm dia.)	
bolt through	453/295BF	
	45.00	
back to back	453/295BB	
	92.00	



	100mm centres (30mm dia.)	
bolt through	455/210BF	
	47.00	
back to back	455/210BB	
	96.00	

push plates



300 x 75mm		
plain	485A	2.77
'PUSH'	485B	10.00
'PULL'	485C	10.00
radiussed	486	6.67

kick plates



1.5mm	487A	63.00
3mm	487B	70.00
price is per square metre		

cabinet handles



64mm	482C	1.70
96mm	482E	1.80

signage



DDA states that signs are to be produced in highly contrasting colours (between the letters/symbol and the background). The reason being that whilst only a small percentage of the population are blind, a much greater percentage of people are partially sighted - especially amongst the elderly. Please refer also to the Signage section of this catalogue for braille and emergency exit signs.

150 x 150mm	
464S...	6.90

please suffix code with:
'D' for less able
'M' for male
'F' for female



100 x 150mm	
464...	6.90

please suffix code with:
'D' for less able
'M' for male
'F' for female

letter plates & tidies

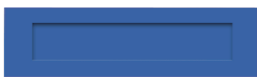

305mm	466A	40.00
355mm	466B	41.67
405mm	466C	44.33



254mm	467A	10.00
305mm	467B	11.57

bolts



150mm	469A	14.63
200mm	469B	17.90



200mm	468	26.43
-------	-----	--------------

door stops



472	7.50
-----	-------------



75mm	470	12.33
------	-----	--------------



75mm	471	9.00
------	-----	-------------

hat & coat hooks



475B	2.50
------	-------------



475A	5.03
------	-------------

toilet roll holder



478	8.77
-----	-------------

card frame



484	16.20
-----	--------------

cupboard knob



25mm dia.	482A	4.80
32mm dia.	482B	5.20

cylinder pulls



blank	495P	7.50
round	495S	8.33
oval	495U	8.33
euro	495Y	8.33

cubical fittings

New to our extensive range of nylon furniture and fittings are a selected number of items ideally suited for cubical doors in washroom and swimming pool changing rooms. These extensions to the range are available in the same choice of 20 colours of nylon.

partition hinges



two piece hinge with two nylon caps inserts made of 3mm steel plate concealed fixing matching washers available



		LH	RH
non rebated doors	H76 x W57.5mm	4##	4##
matching washer (non-handed)	1mm	##.##	##.##
matching washer (non handed)	2mm	4##	##.##
		LH	RH
non rebated doors	H76 x W71.5mm	4##	4##
matching click-on washer	3mm	##.##	##.##
		LH	RH
non rebated doors	H76 x W58.5mm	4##	4##
spring hinge non rebated doors	H76 x W58.5mm	4##	4##
		LH	RH
hinge for partition walls with wraparound profile	H76 x W73mm	4##	4##
spring hinge for partition walls with wraparound profile	H76 x W58.5mm	4##	4##
		LH	RH
rising hinge	H76 x W71.5mm	4##	4##
falling hinge	H76 x W71.5mm	16.43	16.43
matching click-on washer	3mm	4##	4##
		LH	RH
		##.##	##.##

partition foot elements concealed screw fixing



20mm dia. 4## 3.02



40mm dia. 4## 3.67

horizontal rim lockset right or left-hand mounting



4## 32.40

upright rim lockset handed



4## 32.40

washroom pictograms

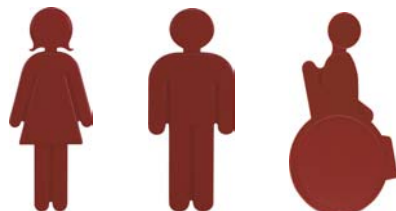

less able 4## 11.23
 female 4## 11.23
 male 4## 11.23